

## Female Replacement Washers

**Feature:**

- for use with female internally expanded permanent couplings on page 97

Size	Buna Part #
3/4"	<b>H5071-BU</b>
1"	<b>H5072-BU</b>
1 1/4"	<b>H5073-BU</b>
1 1/2"	<b>H5074-BU</b>
2"	<b>H5075-BU</b>
2 1/2"	<b>H5076-BU</b>
3"	<b>H5077-BU</b>
4"	<b>H5078-BU</b>



Hose Coupling  
Systems

## HB Coupling Expander Machine

**Features:**

- hand operated, pull-through type expander
- for use in a fixed location for small production runs or as a portable repair type expander
- attaches sizes 3/4" through 2" of the Scovil style and all sizes of the curb pump fittings
- expander tooling sold separately

Part #
<b>2500HB0000</b>



## Permanent Pump Hose Couplings



**Application:**

- economical and trouble-free couplings for gas pump hose

**Features:**

- serrations on the stem embed in the hose eliminating wicking and leakage
- shell extends beyond the stem preventing cutting of interior walls; tapered ends of stem and shell protect hose when flexed
- provide tamper-proof static connection which cannot be broken without completely damaging coupling and hose
- internal expansion of stem to nominal ID of hose provides full flow
- broad, firm grip of coupling extends hose life by making it possible for hose to withstand more flexings
- Hand and electrically operated installation equipment is available; consult Dixon® for pricing and availability.
- UL listed
- *Reattach static wire if required.* 

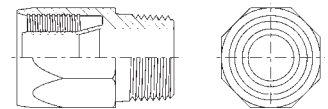

Size	Male NPT	Hose OD	Chrome Plated Brass Part #
3/4"	3/4"	1-13/64"	<b>H5753</b>
3/4"	3/4"	1-7/32"	<b>H5754</b>
3/4"	3/4"	1-17/64"	<b>H5755</b> <sup>1</sup>
1"	1"	1-25/64"	<b>H5771</b>
1"	1"	1-29/64"	<b>H5772</b>
1"	1"	1-1/2"	<b>H5773</b>
1"	1"	1-9/16"	<b>H5774</b>

<sup>1</sup> thrust plate required, part # **2500HTL15**